



**The Chimes, Bearsted, Maidstone, , ME14 4RE**  
**Offers In Excess Of £300,000**





**\*\* GUIDE PRICE: £300,000 - £325,000 \*\* LARGE GARAGE \*\* NO FORWARD CHAIN \*\*** Discover an exquisite first-floor apartment boasting luxury and convenience, nestled within a tranquil residential development just off Ware Street in Bearsted. This stunning property, constructed approximately 17 years ago to an exceptional standard, welcomes you with a spacious entrance hall that features ample storage.

The generous sitting and dining area is bathed in natural light, enhanced by elegant French doors that open onto a private balcony overlooking beautifully maintained rear gardens, perfect for enjoying your morning coffee or evening relaxation. The superb fully fitted kitchen is adorned with sleek granite work surfaces, ideal for culinary enthusiasts. Retreat to the expansive principal bedroom, complete with a modern en-suite shower room designed for comfort and style. A well-appointed bathroom serves guests and residents alike, ensuring convenience.

Additional benefits of this remarkable residence include a convenient lift, the luxury of underfloor heating, and undercroft parking which leads to a garage featuring an electric roller shutter door for added ease of access. The property also enjoys meticulously landscaped communal gardens to rear.

Tenure: Share of Freehold. Council Tax Band: D. EPC Rating: C  
Lease: 999 years remaining  
Ground Rent: £0  
Service Charge: £260 pcm



## LOCATION

The property is ideally located to take full advantage of all local amenities within Bearsted, particularly the excellent transport links via mainline train station and access to the M20 motorway, together with its close proximity to the renowned Thurnham & Roseacre Schools and picturesque village green with a selection of pubs and restaurants. Leisure facilities include Bearsted golf, bowls and tennis clubs, nearby leisure centres, whilst the beautiful grounds of both Leeds Castle and Mote Park are also close by.

## GROUND FLOOR

Communal Entrance

## FIRST FLOOR

Entrance Hall

Sitting/Dining Room

Kitchen

Balcony

Bedroom One

En-suite Shower Room

Bedroom Two

Bathroom

## EXTERNALLY

Communal Garden

Car Port

Garage

## VIEWING

Strictly by arrangement with the Agent's Bearsted Office, 132 Ashford Road, Bearsted, Maidstone, Kent ME14 4LX. Tel: 01622 739574.

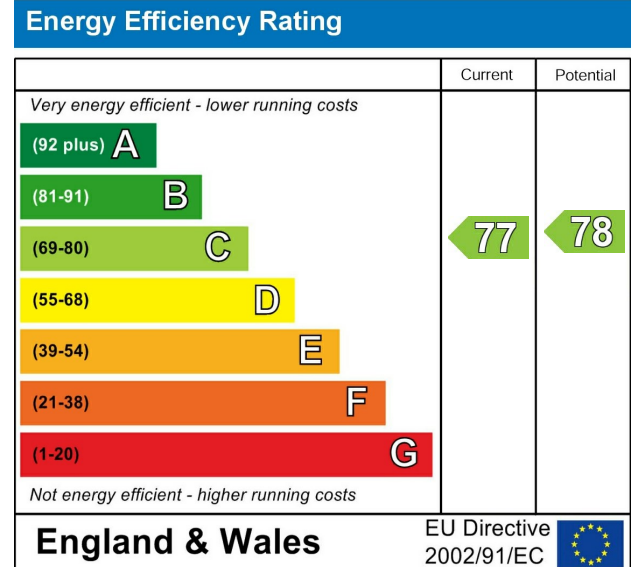



**The Chimes, Maidstone, Kent**  
**Approximate Gross Internal Area**  
**Main House = 848 Sq Ft/79 Sq M**  
**Garage/Carport = 427 Sq Ft/40 Sq M**  
**Balcony external area = 53 Sq Ft/5 Sq M**  
**Total = 1275 Sq Ft/119 Sq M**

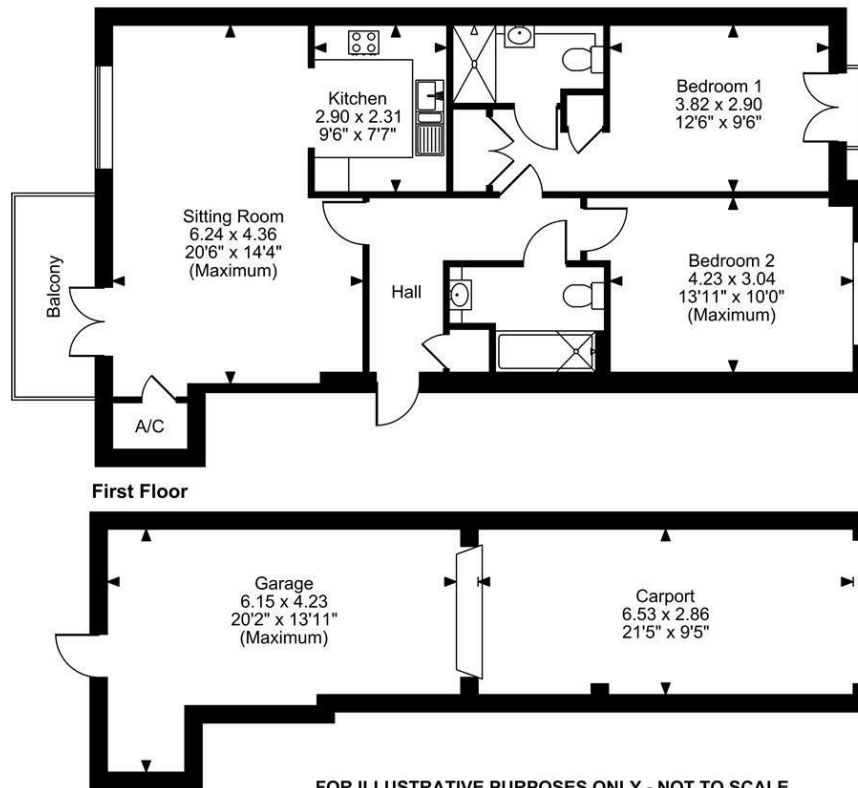
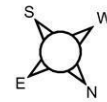

**FOR ILLUSTRATIVE PURPOSES ONLY - NOT TO SCALE**

The position & size of doors, windows, appliances and other features are approximate only.  
 © ehouse. Unauthorised reproduction prohibited. Drawing ref. dig/8628365/LCO

